

**NOTE: DO NOT DISCARD the Parts List from the Instruction Bulletin. Place the Parts List in the appropriate place in the machine manual for future reference. Retaining the Parts List will make it easier to reorder individual parts and will save the cost of ordering an entire kit.**

*NOTE: Numbers in parenthesis ( ) are reference numbers for parts listed in Bill of Materials.*

Installation instructions for **kit number 367618**

## SYNOPSIS:

This kit contains the parts needed to install a deluxe suspension seat kit on the 4300 machine. Please follow step-by-step instructions.

## SPECIAL TOOLS / CONSIDERATIONS: NONE

(Estimated time to complete: 1 hour)

## PREPARATION:

1. Park the machine on a clean level surface, turn off the machine, remove the key, and set the parking brake.

**FOR SAFETY: Before leaving or servicing machine, stop on level surface, set parking brake, turn off machine, and remove key.**

## INSTALLATION:

1. Open the seat plate. Remove the old seat and seat mounting hardware. Discard seat and hardware.
2. Use the four pan screws (2), four washers (3), and four lock nuts (4) to install the new suspension seat (1) onto the seat plate. Refer to Fig. 1.
3. Install hex screw (5), washer (7), and nut (6) onto the seat plate. These parts will function as a sliding seat stop. Refer to Fig. 1.
4. Use hardware included with arm rests (9) and (10) to install the arm rests onto the suspension seat (1). Refer to Fig. 1.
5. Close seat plate and check the suspension seat (1) for proper operation.

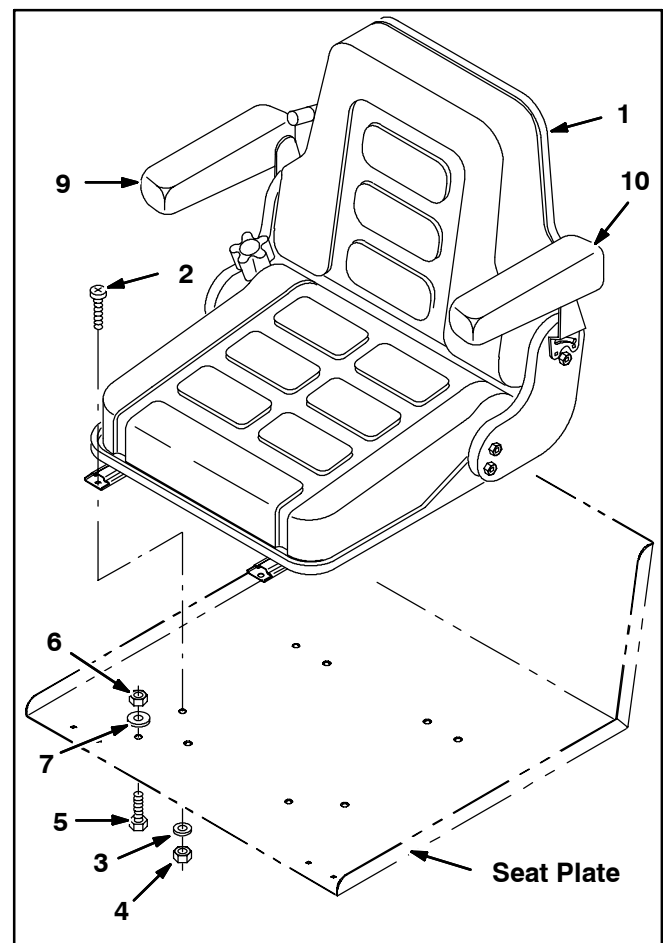

FIG. 1

---

**Bill of Materials for Seat Kit, Suspension, Dlx [4300]-367618**

	<b>Ref.</b>	<b>Tennant Part No.</b>	<b>Description</b>	<b>Qty.</b>
▽		367618	Seat Kit, Suspension, Dlx, [4300]	1
▲	1	367740	Seat, Dlx, w/o Arm [Grammer #128001]	1
▲	2	09737	Screw, Pan M8 X 1.25 X 20, 4.8	4
▲	3	32491	Washer, Flat. 0.31, Std	4
▲	4	08709	Nut, Hex, Lock, M8 X 1.25, NL	4
▲	5	15675	Screw, Hex, 8 X 1.25 X 16, SS	1
▲	6	07786	Nut, Hex, Std, M8 X 1.25, SS	1
▲	7	01685	Washer, Flat, 0.38B 0.88D .08, SS	1
▲▽	8	34252	Armrest Assy, F/69968 [Grammer]	1
▲▲	9	61765	Armrest, RH	1
▲▲	10	72140	Armrest Assy, LH, F/53845 [Grammer]	1

TENNANT COMPANY  
P. O. Box 1452  
Minneapolis, MN 55440-1452